

16/01/33

The purpose of this drawing is to show the number and position of floor outlet boxes relative to desk positions.

Desk layout is indicative only.

140no. boxes to be fitted in positions as shown; 10no. boxes to be fixed to carpeted floor panels and stored loose meantime.

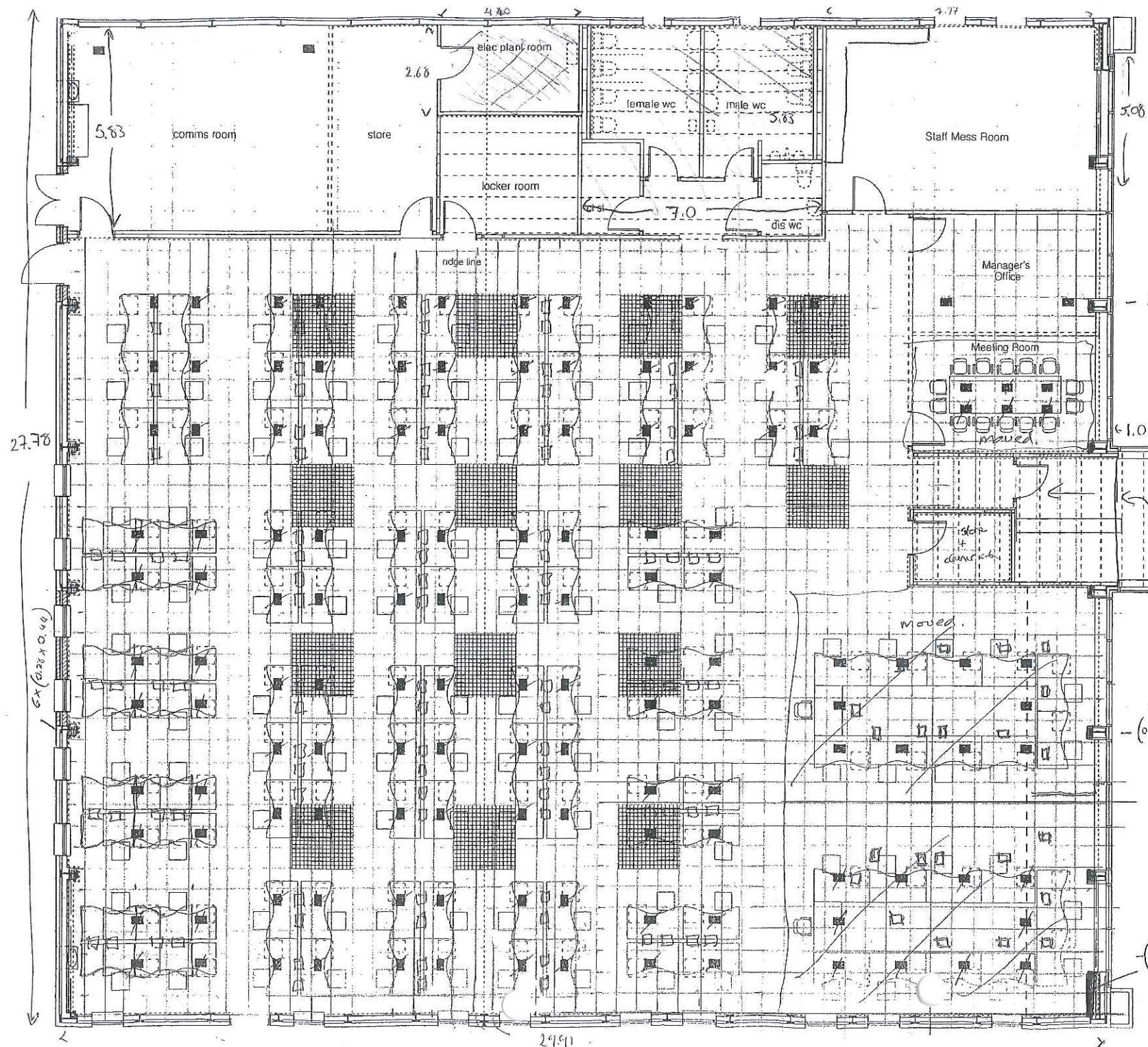

3x (0.34 x 0.38)

3.99
 830.90
 - (55.50)

 775.39 / 8384

doc: 11.74
 wgs: 41.78
 0.74
 53.50

16 MAR 1999

TULLOCH CONSTRUCTION GROUP LTD.

project
 Alterations to 10,000 sq.ft. Factory Unit
 at 4 Dall nan Rocas
 Tearnich Ind. Est., Aines

subject
 Floor Box Layout
 (indicative desk layout)

scale	date	drawn
1:100	11.03.99	ll

Trevor Black
 Chartered Architects
 64 High Street
 Invergordon, IV18 0DH
 Tel: 01349 853159
 Fax 01349 854013

1274	305
------	-----

3x (0.34 x 0.38)

(0.64 x 0.35)

29.91